

June 2020

ANTICOLLISION LIGHT
MINI BEACON

FUSELAGE OR RUDDER

MODELO N° SAS-138M – MINI BEACON

Can be installed on fuselage or Rudder.

MODEL N° SAS-138M

Strobe Effect RED Super Bright

length 55,0 mm

wide 40,0 mm

height 38,0 mm

weight 50,0gr

Consumption Estrobe 1,6A @ 13.8V - Pick

Anti collision Estrobe Light - LED High Brightness “Red” **Three 3 Flashes**
Synchronize to all Simplepack lights.



EXPERIMENTAL AIRCRAFT ONLY

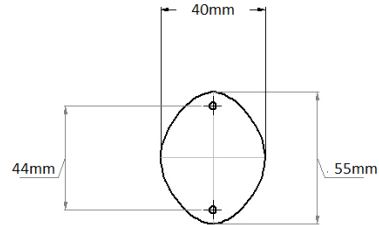

IF YOU ARE NOT INSTALLING OTHER SIMPLEPACK PRODUCTS, PLEASE KEEP GREEN WIRE CONNECTED TO (GND - BLACK)

PLEASE AVOID ELECTROSTATIC DISCHARGE ON WIRES UNCOVERED LEADS

PLEASE AVOID

- START OR SHUT ENGINE OFF WHEN LIGHTS ARE ON
- DO NOT TURN LIGHTS ON IF YOU ARE USING BATTERY CHARGER
- VOLTAGE RANGE 10~15 VOLTS
- NEVER JUMP START ENGINE WITH LIGHTS ON

